

*Application does not view or function correctly on a smartphone. Please use a computer or tablet.

Never logged in to Parent Portal?

Your school provided you with an Activation Key when you registered your student. Use this key to create your user account. If you don't know your key, contact your school and the secretary can locate it for you. Once you have that key:

- If using the **Campus Parent** mobile app, open the app and search for your **District Name** and **State**.
 1. Click **New User?**
 2. Enter your **Activation Key** in the space provided and then **Submit**.
 3. Enter a **Username** and **Password** and click **Submit**.

- If using a web browser, visit <https://www.nebo.edu/> and from the Parents tab, select **Infinite Campus Parent Portal**.

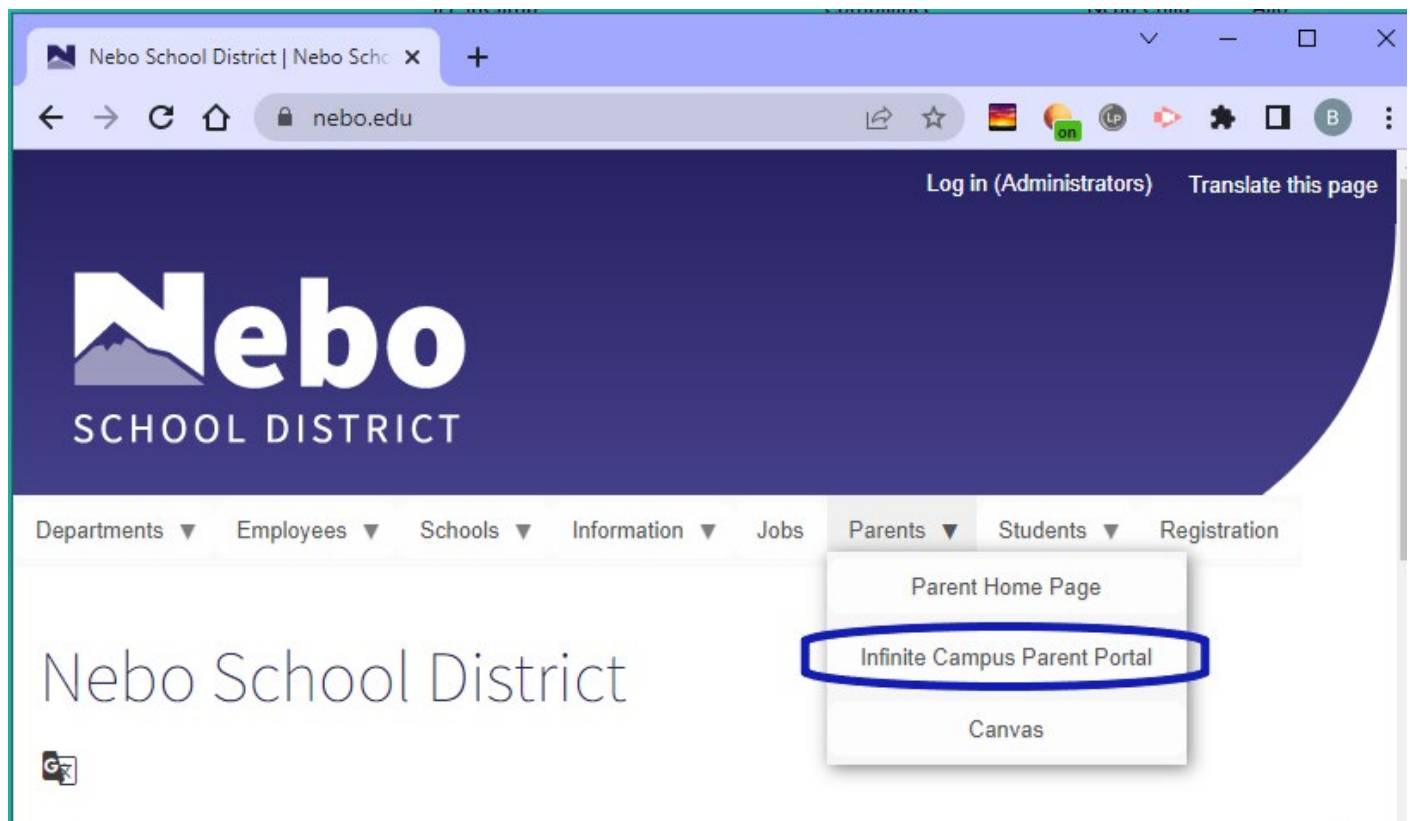

Login to your parent portal by entering your Parent Username and Password left of the screen and click **Login**

Campus provides displays in English, Spanish, and Chinese

****to change the display language of your portal **Before log in:** – scroll to the bottom and select ENGLISH or SPANISH from the dropdown box**

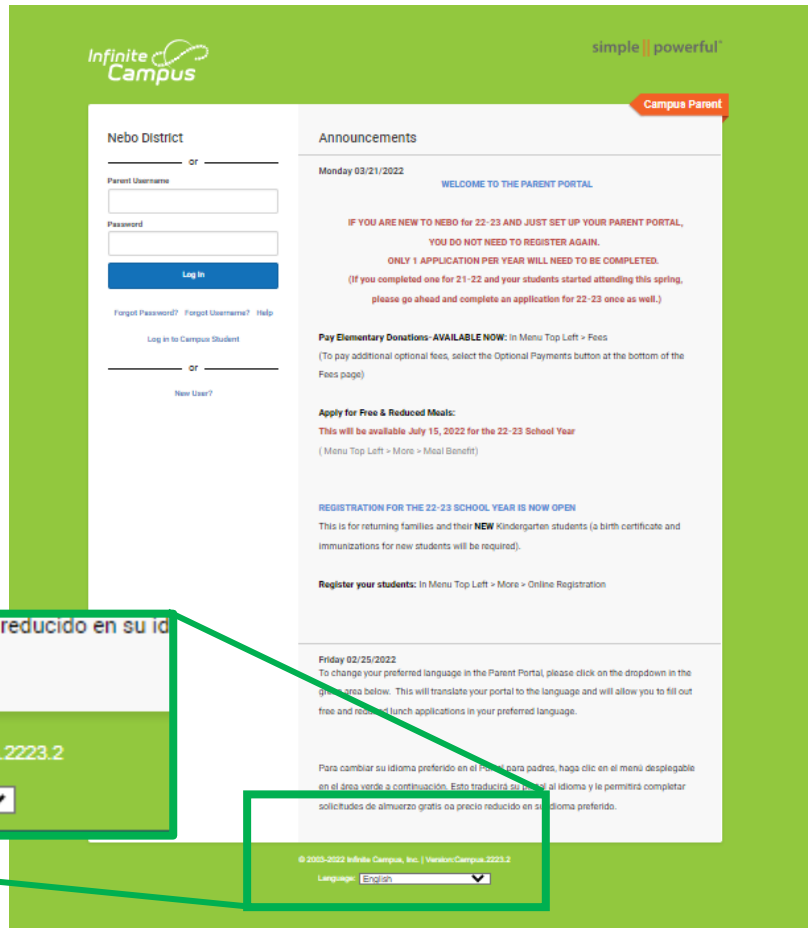

****to change the language of your portal to English or Spanish **Once logged in:** - From the user menu, click **Language** to change the language that Campus Parent displays in.**

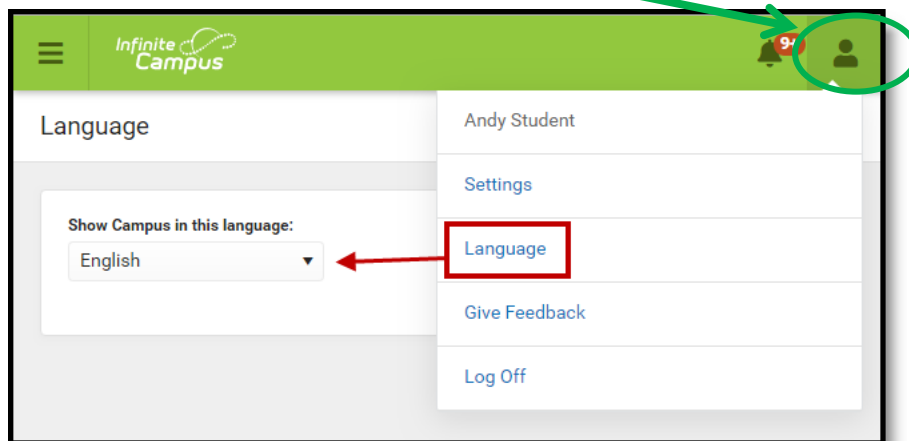

At the main screen, if you do not see the menu (black on left), select the “hamburger” or “three bars” icon.

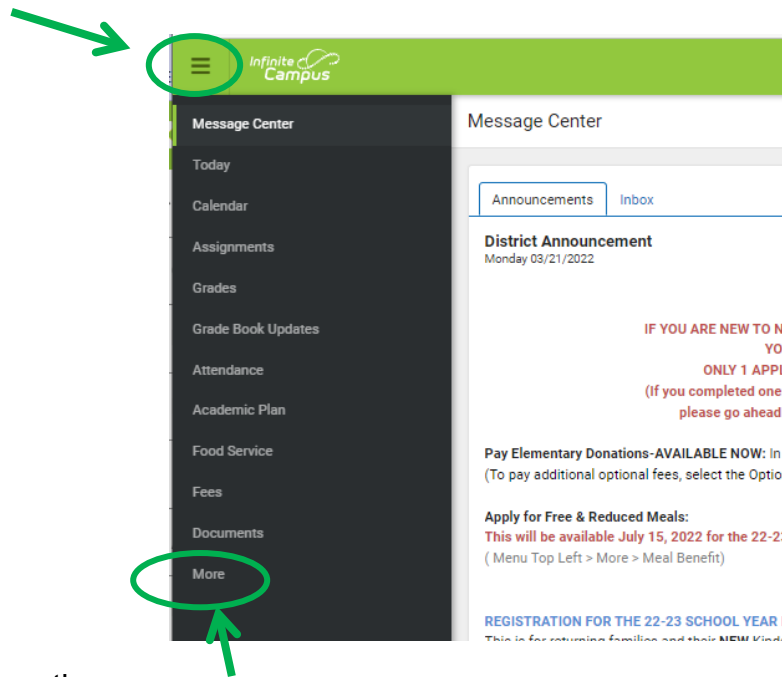

Select **More** from the menu

From the **More** menu, select **Meal Benefits**

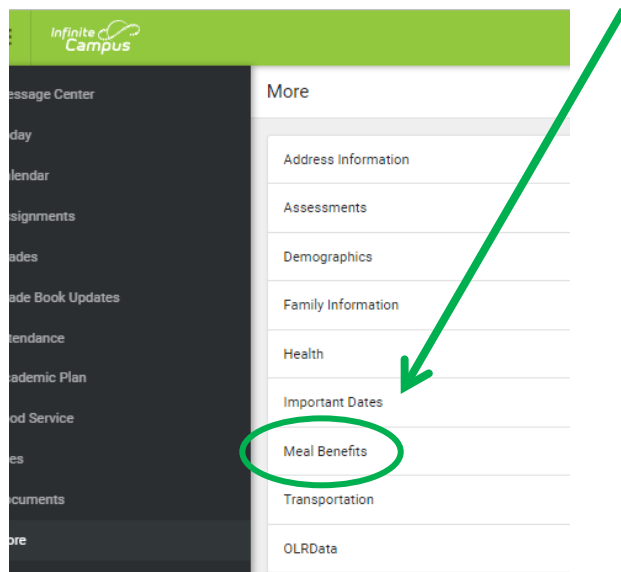

Click to start the application process

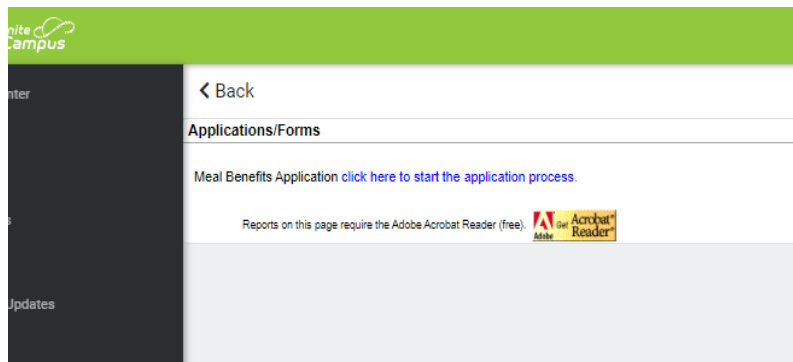

If you do not already have an E-Signature PIN setup, you will be asked to setup the pin. You will use this pin to e-sign and submit the application. Select YES to create your pin.

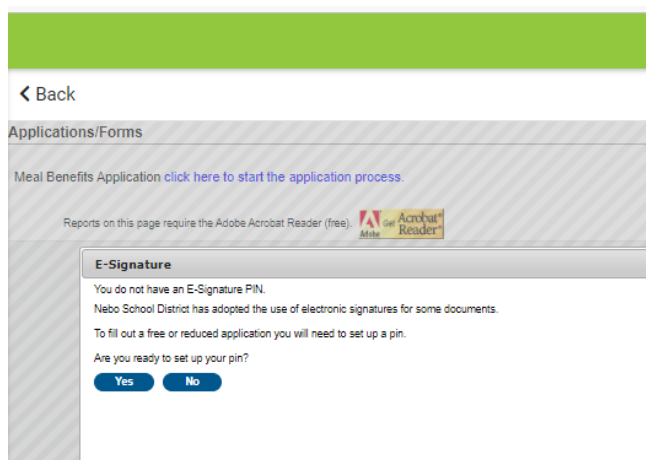

Create your PIN:

- Enter five (5) letters, numbers or special characters (!@#\$%^&*+?~|=).
- You must have at least one (1) of each of two (2) of the types.

Re-enter PIN

Password:

*this is your Parent Portal Password.

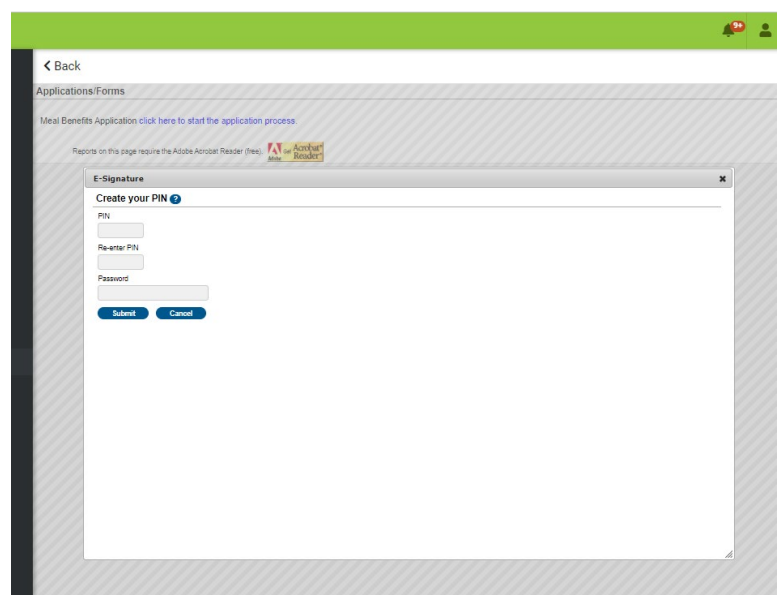

9+

< Back

Applications/Forms

Meal Benefits Application [click here to start the application process.](#)

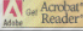
Reports on this page require the Adobe Acrobat Reader (free). 

Meal Benefits Application

Letter to Household > Instructions > Signer Confirmation > Household Members > Children > Gross Income > Review > Authorization > Submitted

Letter to Household contains important information you will need during the application process. You may print a PDF of this letter by selecting the print icon. Select 'Next' to continue or 'Quit' to stop.

1 of 3

Letter to Household

Dear Parent/Guardian:

Children need healthy meals to learn. Nebo School District offers healthy meals every school day. Breakfast and lunch meals are FREE for the 2021/22 school year. This packet includes an application for free or reduced price meal benefits, and a set of detailed instructions. Below are some common questions and answers to help you with the application process.

1. WHO CAN GET FREE OR REDUCED PRICE MEALS?

Quit Next

Timeout 59:49

9+

< Back

Applications/Forms

Meal Benefits Application [click here to start the application process.](#)

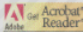
Reports on this page require the Adobe Acrobat Reader (free). 

Meal Benefits Application

Letter to Household > **Instructions** > Signer Confirmation > Household Members > Children > Gross Income > Review > Authorization > Submitted

Application Instructions will help guide you through the application process. You may print a PDF of this letter by selecting the print icon. Select 'Next' to continue.

1 of 3

How To Apply For Free And Reduced Priced Student Meals

You are submitting an application for the 21-22 School Year. Application Instructions will help guide you through the application process.

It is recommended you gather any household income information needed and review your household members in the Household Information section of the Portal for accuracy prior to starting the online application. The USDA's definition of a household member is any child or adult living with you.

An electronic signature PIN is required to submit your online Meal Benefits Application. If you do not have an electronic signature PIN created you will be required to do so prior to starting your online Meal Benefits Application. Prior to submitting your application you will be allowed five attempts to enter your PIN. If you fail on the fifth attempt you will be locked out and the information you entered will be lost. Your PIN will need to be used prior to submitting a new online Meal Benefits Application.

For security purposes the Campus Portal is set to automatically log users out after a set amount of time due to inactivity. To avoid presenting an automatic log out due to inactivity, there is a timer located in the bottom right corner of each screen. As you navigate to each screen, the timer will start to count down and alert you when there is five minutes remaining. If you are logged out due to inactivity prior to reaching the final 'Submitted' step, the information will not be saved and you will have to restart the online application process.

Signer Confirmation

Please review the application signer's name and household address below. Confirm you are the person signing this online application by selecting 'Next'. Select 'Quit' if you are not the person or if you do not wish to continue.

You are applying for meal benefits for all household members living at the address below. If the address is incorrect,

Previous Next

Timeout 59:56